

GUILDHALL

CONFERENCES & EVENTS



THE SOUTH COAST'S MOST UNIQUE, ICONIC & VERSATILE CONFERENCE VENUE

Portsmouth Guildhall has a range of conference and meeting spaces available to accommodate between 2 and 2000 delegates for all types of events and budgets.



Immerse your delegates in the historic grandeur of this unique and iconic venue.

Portsmouth Guildhall has a range of conference and meeting spaces available to accommodate between 2 and 2000 delegates for all types of events.

Located in the heart of Portsmouth, easily accessible by road or rail with car parking in the vicinity, the Guildhall is a flexible venue available for part or exclusive use, offering quality on-site catering and in-house technical support, Corporate Hospitality opportunities and excellent value for money.

With 125 years of experience hosting world-class events, your event is safe in our hands. Our dedicated team will guide you from your initial enquiry to post event, ensuring every detail is meticulously planned and accomplished.



THE MAIN AUDITORIUM

Perfect for large-scale events

A flexible space with the wow factor, the Main Auditorium can be dressed to fit all types of event from large exhibitions and conferences to dinners and parties.

Easily accessible on the ground floor, the space has its own stage, draping and curtains with options to screen off sections if required.

SPACE DETAILS

Theatre: Up to 2009 people
Reception: Up to 1000 people
Buffet: Up to 800 people
Dinner: Up to 420 people
Dinner Dance: Up to 380 people
Cabaret: Up to 336 people
Classroom: Up to 300 people
Dimensions: 29 x 18m
Ceiling height: 13m
Area: 552m²

FEATURES

-  Conference option
-  Food option
-  Meeting option
-  WiFi
-  Induction loop
-  Blackout blinds
-  Technical support



Image Credit: Clipper Round the World Race

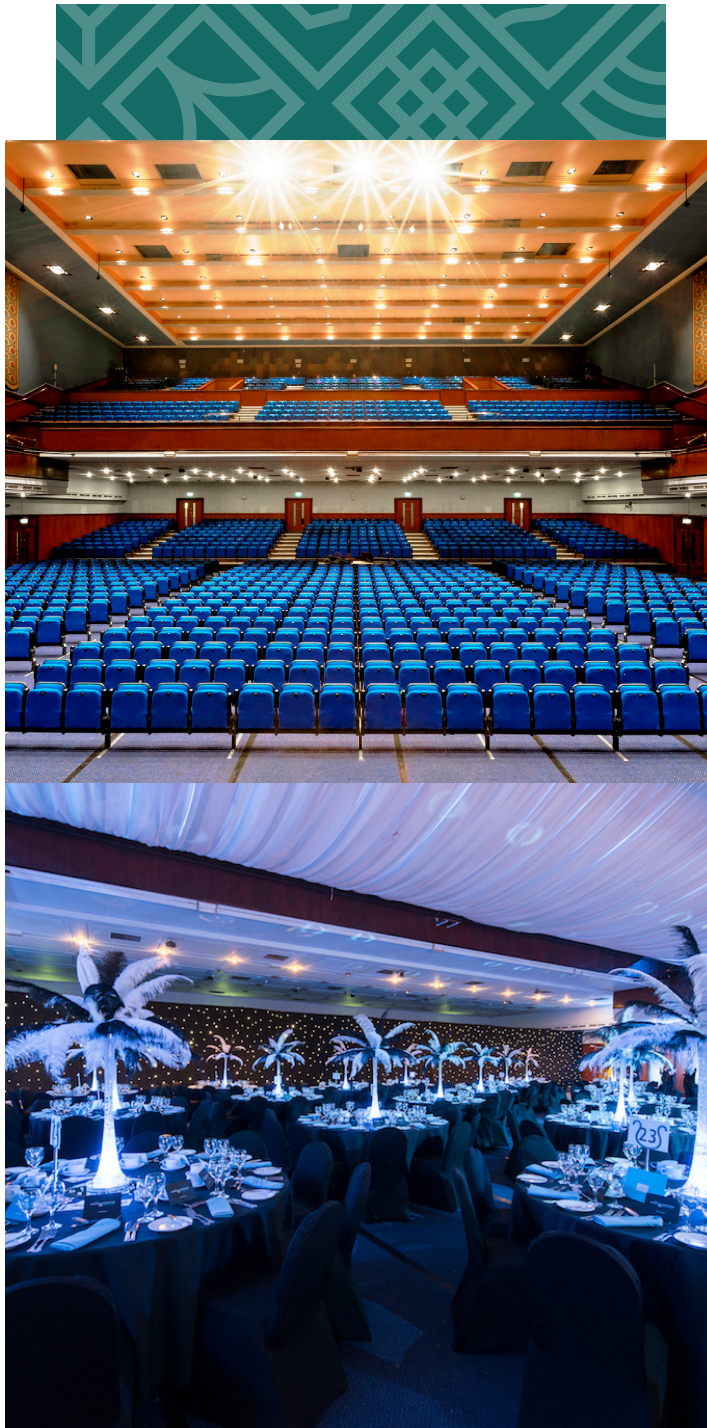

FLOOR PLAN

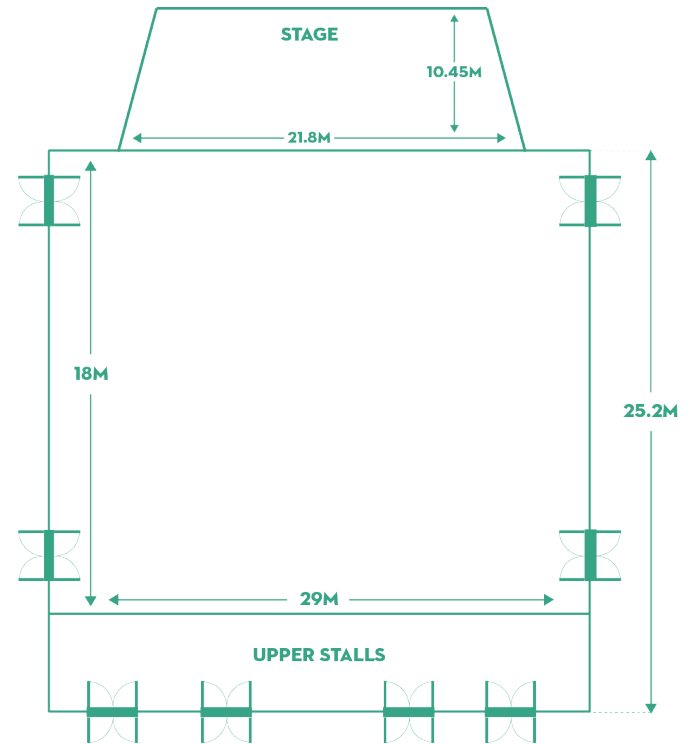

“The teamwork: security, reception, catering, backstage all knew what was happening when and information flowed seamlessly between them as needed.”

Conference Organiser, 2019

GUILDHALL STUDIO

A fresh and versatile new space for up to 210 delegates.

Following a £130,000 investment, the Guildhall Studio is now available for conferences, meetings, dinners and team building for up to 170 delegates seated or 210 standing reception.

Bathed in natural light, the accessible ground floor Studio benefits from its own entrance, full AV and tech support, highly acclaimed on site catering and can be set in traditional or contemporary formats.

SPACE DETAILS

Theatre: Up to 170 people

Buffet/Reception: Up to 200 people

Cabaret:

Up to 72 people

Boardroom: Up to 40 people

Dimensions: 14 x 12m

Ceiling height: 5m

Area: 168m²

FEATURES

-  Conference option
-  Food option
-  Meeting option
-  WiFi
-  Induction loop
-  Blackout blinds
-  Technical support



FLOOR PLAN

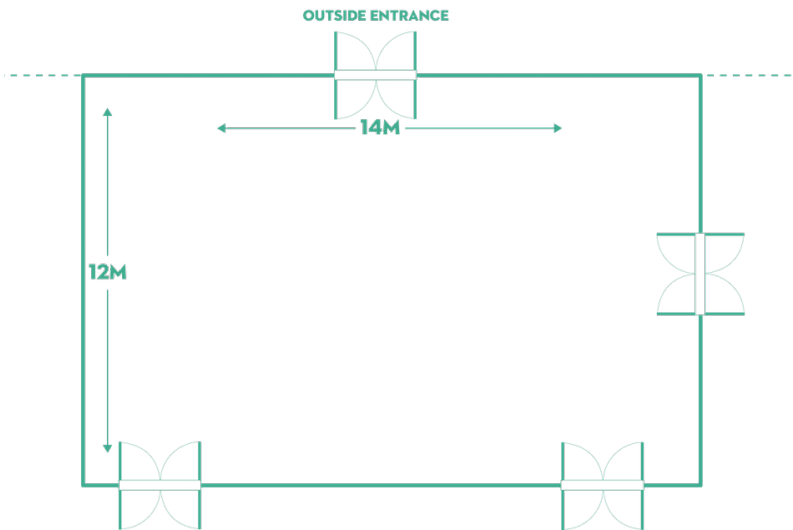

“The Studio is so versatile – we’ve used it in a number of different formats for our events!”

Event Organiser, 2019



THE PORTSMOUTH ROOM

An elegant, light-filled space with iconic décor that creates a stunning backdrop to any event.

Located on the first floor, the Portsmouth Room is perfect for conferences, meetings, team building events and dinners and is complete with its own bar and lounge area.

SPACE DETAILS

Reception: Up to 100 people

Theatre/Buffer: Up to 100 people

Dinner: Up to 80 people

Cabaret: Up to 64 people

Dinner Dance: Up to 60 people

Board Room: Up to 40 people

U-Shape: Up to 25 people

Dimensions: 15.6 x 7.12m

Ceiling height: 4m

Area: 160m²

FEATURES



Conference option



Food option



Meeting option



Natural daylight



WiFi



Technical support



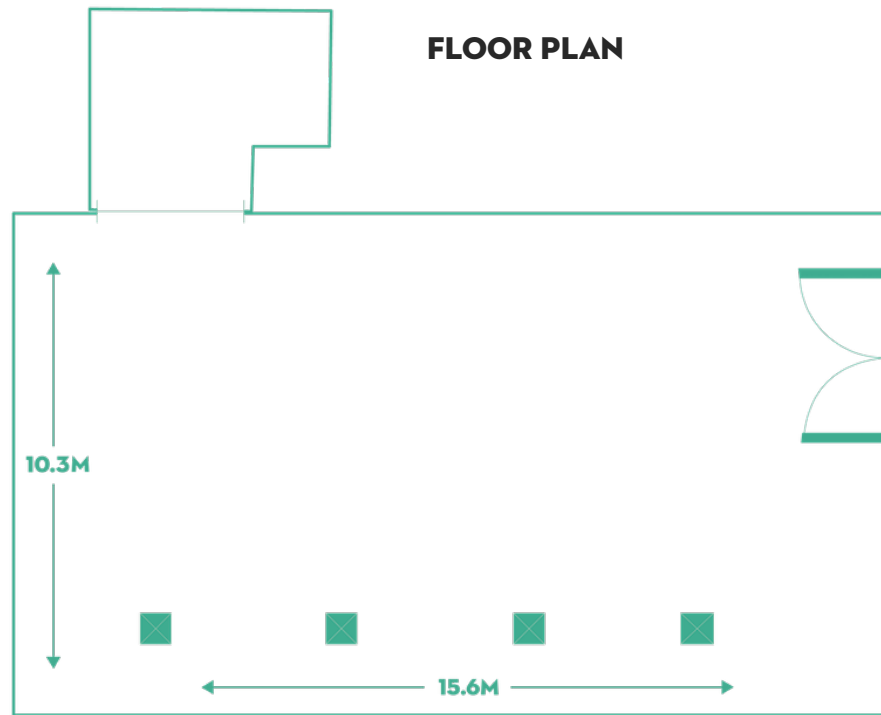

“From start to finish, your team was very helpful and experienced. Your team were also very flexible and helpful for the last minute changes.”

Conference Organiser, 2018



THE ZODIAC GALLERY

Featuring the largest acid-stained glass mural in the world, this exquisite space offers something a little different for your event.

Located on the first floor overlooking Guildhall Square, the Zodiac Gallery is perfect as a meeting, dining or break out space.

SPACE DETAILS

Reception: Up to 200 people

Theatre: Up to 90 people

Dinner: Up to 80 people

Cabaret: Up to 56 people

Dinner Dance: Up to 80 people

Board Room: Up to 30 people

U-Shape: Up to 25 people

Dimensions: 15.6 x 10.3m

Ceiling height: 4m

Area: 160m²

FEATURES



Conference option



Food option



Meeting option



Natural daylight



WiFi



Technical support



FLOOR PLAN

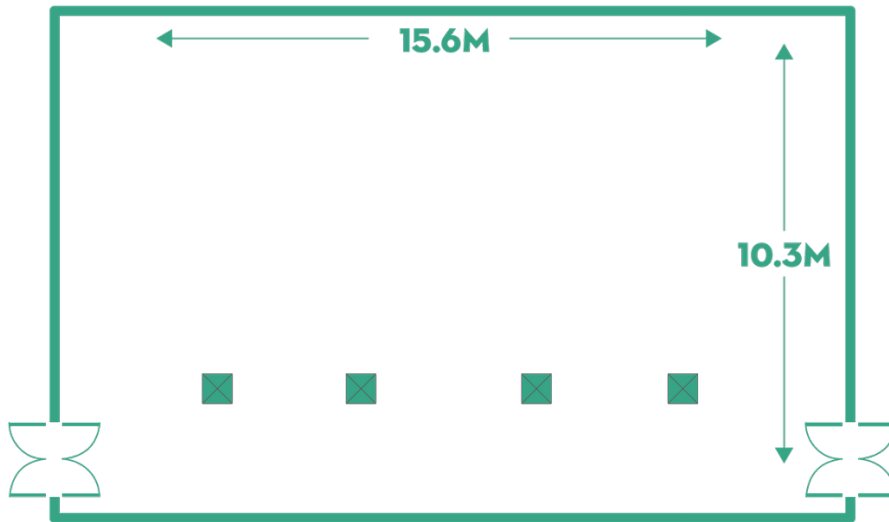

“We love this beautiful, light space and its central location.”

Event Organiser, 2018



THE FREDA SWAIN LOUNGE

Adjacent to the Zodiac Gallery, this charming space has floor to ceiling windows, a bar and stunning views across Guildhall Square.

Located on the first floor, the Freda Swain Lounge is perfect as a meeting, dining or break out space.

SPACE DETAILS

Reception : Up to 200 people

Theatre: Up to 90 people

Dinner: Up to 80 people

Dinner Dance: Up to 60 people

Cabaret: Up to 56 people

Boardroom: Up to 30 people

Dimensions: 15.6 x 10.3m

Ceiling height: 4m

Area: 160m²

FEATURES



Food option



Meeting option



Natural daylight



WiFi



Technical support

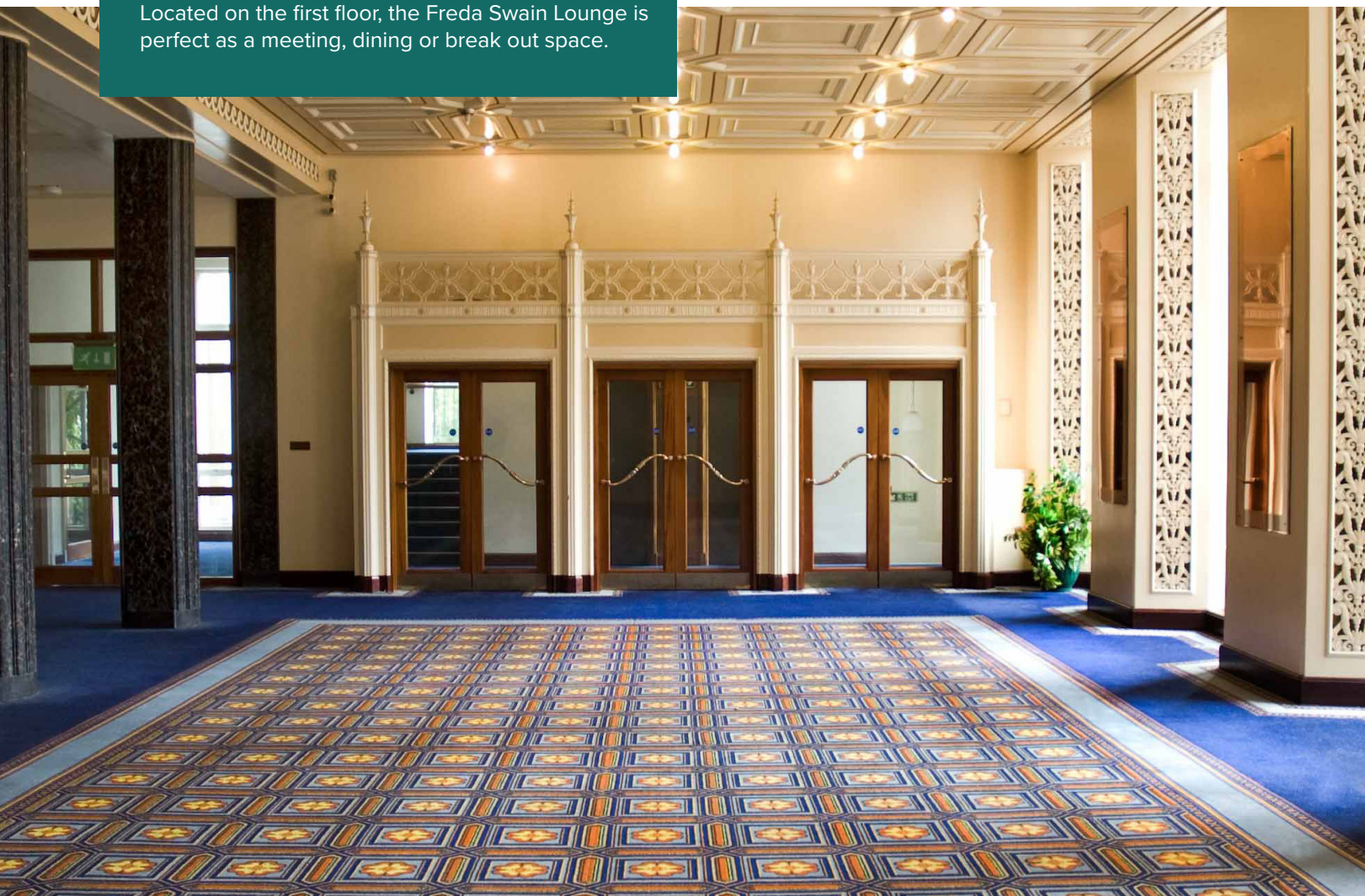

FLOOR PLAN

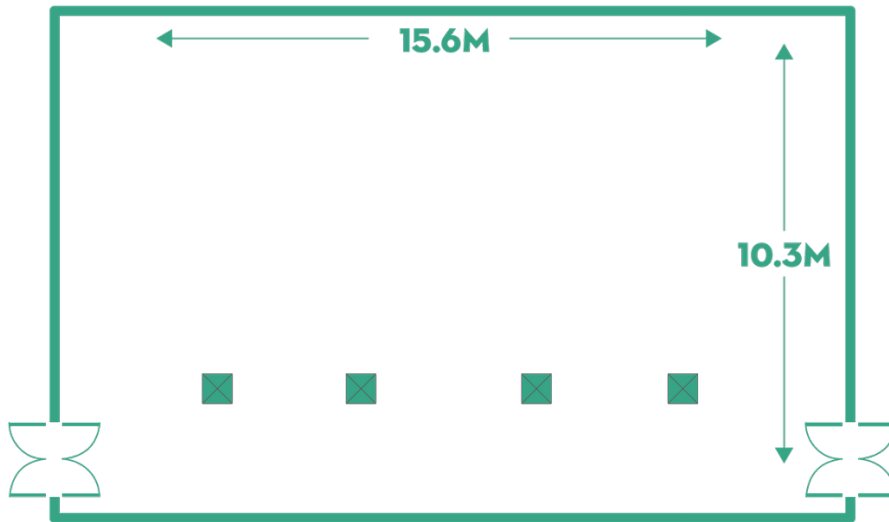

“The Guildhall team were so helpful and efficient and were able to anticipate and solve any problems we had.”

Meeting Organiser, 2018



LORD MAYOR'S BANQUETING ROOM

Rich in history, this decadent room with high ceilings and original features is bathed in natural light from its grand windows.

Located on the second floor, the Banqueting Room offers grandeur fit for the Lord Mayor and is ideal for conferences, meetings and dinners.

SPACE DETAILS

Theatre: Up to 110 people

Reception: Up to 110 people

Buffet: Up to 110 people

Dinner: Up to 100 people

Dinner Dance: Up to 80 people

Cabaret: Up to 66 people

Dimensions: 15.5m x 12.3m

Ceiling height: 13m

FEATURES

-  Conference option
-  Food option
-  Meeting option
-  WiFi
-  Induction loop
-  Blackout blinds
-  Technical support



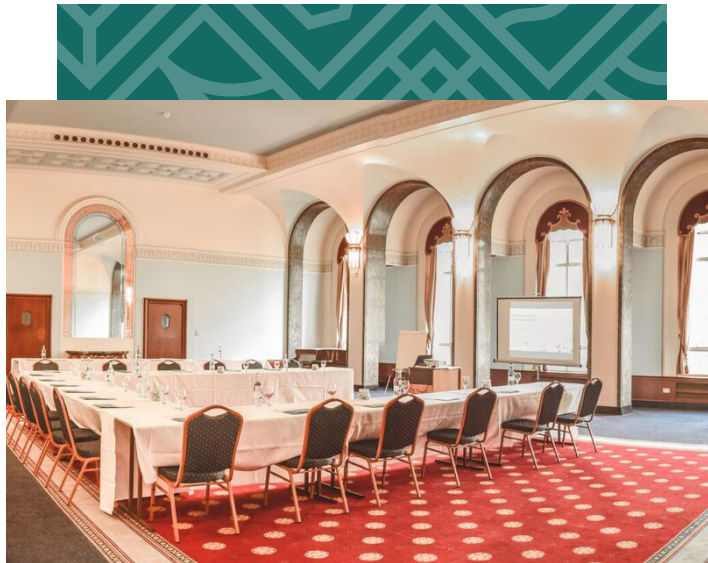

FLOOR PLAN

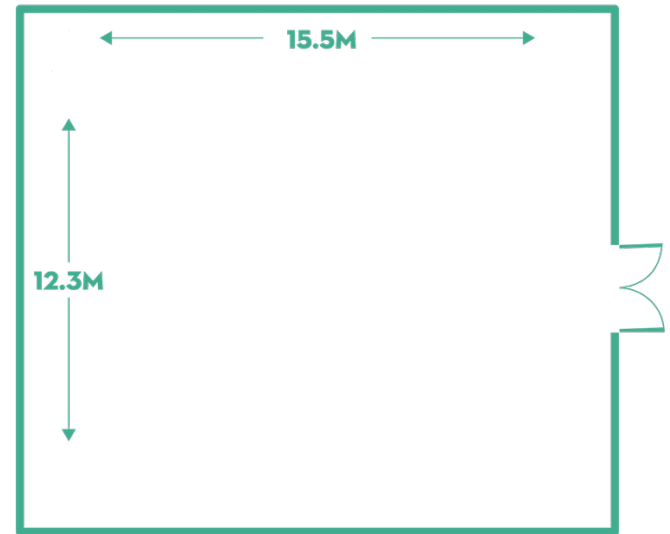

“I have organised events in various venues large and small, but the differences I noticed at Portsmouth Guildhall include the friendly, professional and efficient service from all the teams at all times. They weren’t just there, they took an interest in what we were doing and thought how best to help us.”

Conference Organiser, 2019

MEETING ROOM 1

A bright, spacious and airy room situated on the third floor with views of the iconic clock tower.

Filled with natural daylight and high ceilings, this is a perfect space in the heart of the city for meetings and training sessions.

SPACE DETAILS

Theatre: Up to 40 people

Cabaret/Boardroom:

Up to 25 people

Dimensions: 9 x 7m

Ceiling height: 3m

Area: 63m²

FEATURES



Food option



Meeting option



Natural daylight



WiFi



Technical support





FLOOR PLAN

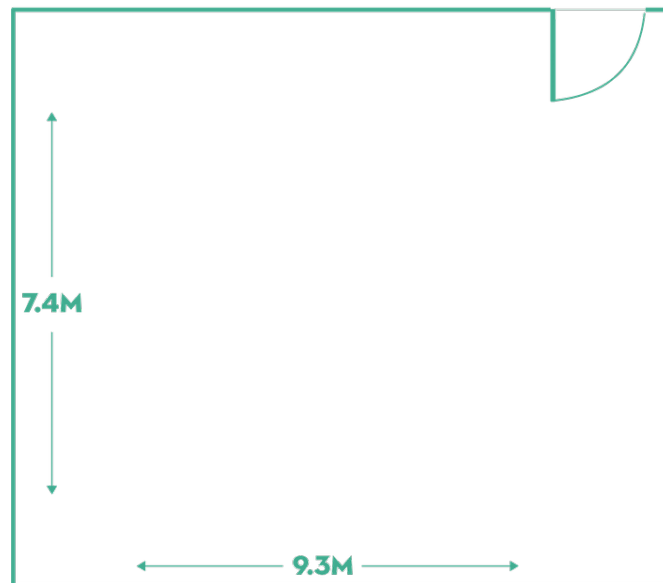

“A really practical space
and the catering is always
amazing.”

Meeting Organiser, 2019

MEETING ROOM 2

The adjoining room to Meeting Room 1 on the third floor, this smaller space is also bright, spacious and airy.

The perfect space in the heart of the city for meetings and training sessions.

SPACE DETAILS

Theatre: Up to 30 people

Cabaret/Boardroom:

Up to 16 people

Dimensions: 6 x 7m

Ceiling height: 3m

Area: 42m²

FEATURES



Food option



Meeting option



Natural daylight



WiFi



Technical support





FLOOR PLAN

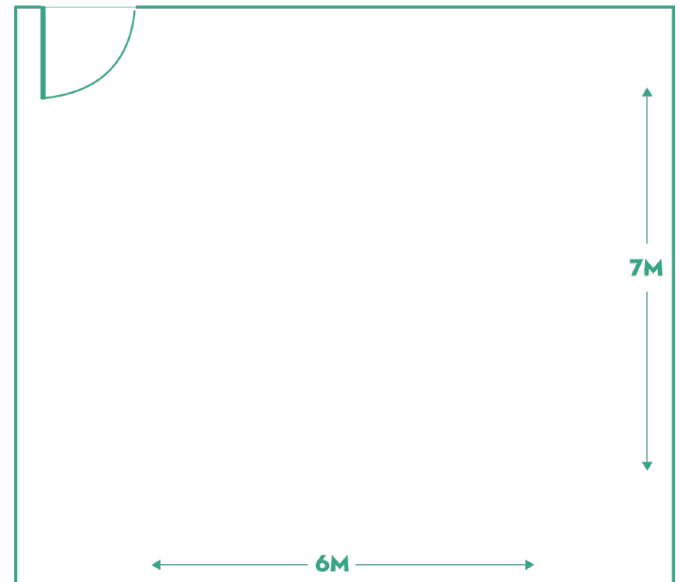

“A bright, airy and functional meeting room serviced by such an attentive team”

Meeting Organiser, 2018

THE SOLENT SUITE

An elegant, light-filled suite with relaxed furniture and décor offering a five star effect is available for corporate hospitality, interviews and small meetings.

FLOOR PLAN



SPACE DETAILS

Boardroom: Up to 5 people

Dimensions: 3 x 5m

Ceiling height: 4m

Area: 14.540m²

FEATURES

-  Food option
-  Meeting option
-  Natural daylight
-  WiFi
-  Technical support



WITH 125 YEARS OF EXPERIENCE HOSTING WORLD-CLASS EVENTS, YOUR EVENT IS SAFE IN OUR HANDS

Quality in-house catering

Using fresh, locally sourced ingredients our renowned Head Chef and his experienced team would be delighted to cater for your event.

A range of breakfast, lunch and dinner menus and refreshment options are available or we would be happy to develop a bespoke menu to suit your requirements.

We cater for all dietary requirements and preferences.

On-site technical support

Our experienced technicians are on hand to ensure your event runs without a hitch.

All spaces can be fully equipped with screens, projectors, lecterns, flip charts, PA and Mics with additional requirements readily available through Guildhall Event Services, our equipment hire and event management service.

Corporate Hospitality

Entertain and impress your guests with tickets to world-class shows and exclusive VIP hospitality options.





PORTSMOUTH - A WELCOMING BUSINESS DESTINATION

Portsmouth is a vibrant and welcoming destination for Conference & Event Organisers, combining a buzzing city atmosphere with world-class attractions, waterfront sports and leisure and 4 miles of seafront to relax and explore.

Situated in the heart of the city, Portsmouth Guildhall is within easy walking distance of many of the city's hotels, restaurants and attractions which include waterfront designer outlet; Gunwharf Quays, King Henry VIII's Tudor ship; Mary Rose, Admiral Lord Nelson's HMS Victory and stunning views from Emirates Spinnaker Tower.

Just 70 miles from London, Portsmouth is well connected and easily accessed from across the UK and beyond.

We are proud to be a founder member
of Portsmouth Convention Bureau.
Portsmouth, the natural destination of
choice for your event.



PORTSMOUTH
Convention Bureau



OUR CLIENTS INCLUDE:



PORTSMOUTH

GUILDHALL

BOOK A SHOW ROUND TODAY!

Victoria Campbell

Conference & Events Sales Manager

Tel: 023 9387 0182

Gemma Rigby

Conference & Events Sales Co-ordinator

Tel: 023 9387 0187

enquiries@portsmouthguildhall.org.uk

www.portsmouthguildhall.org.uk